

MSequence - Automated goods issue

Simple, automatic and intelligent – load supply with the MSequence

Cost drivers and efficiency reducers at goods issue:

- High space requirement
- Loading errors
- Sorting errors relating to unloading points
- Long truck waiting times
- Personnel-intensive
- High complaint costs (returns, credit memos)

The modular solution for future-oriented, efficient and error-free goods issue.

To sustainably lower the costs in goods issue and to increase delivery flexibility and quality, Kardex Mlog has developed the dynamic sorting buffer MSequence. This ensures automatic, error-free and dynamic order staging with an optional display of a truck loading plan. (just-in sequence)

MSequence consists of

- 1 automatic storage and retrieval machine
- 1 storage line, 3 gravity roller tracks for staging
- 1 control technology (Siemens S7)
- Racking
- Security package
- Warehouse management software
- Installation and commissioning
- Training



Film: MSequence - Sorting buffer for goods issue

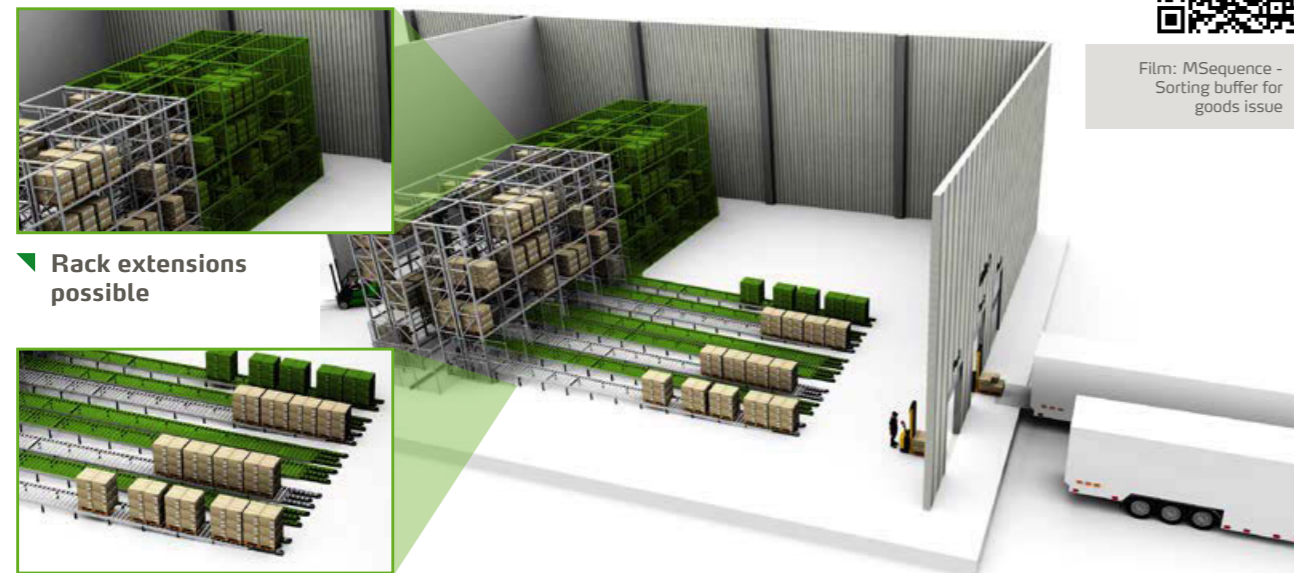

Rack extensions possible

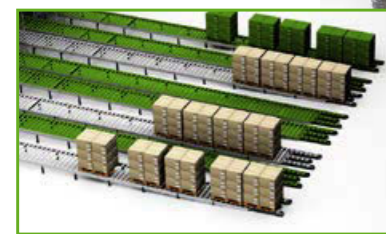

Gravity roller tracks, extendable up to a max. of eight

Automatic staging of the loading orders

High buffer capacity combined with low space requirement

Secure and error-free goods issue

Reduction in waiting times

100 % transparency of the loading operation

Automatic sorting by unloading point (just-in-sequence)

Reduction in personnel and material costs

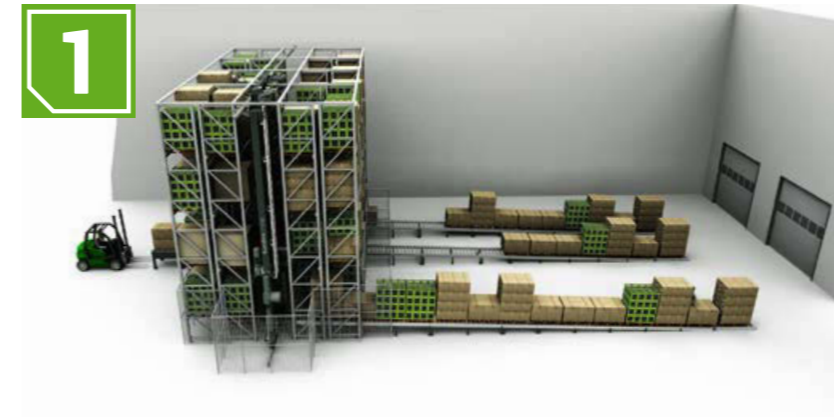

Properties

- Pallet buffer with **double-deep** storage
- Designed for maximum storage and retrieval capacity and space for 5.5 truckloads
- Storage of the pallets in longitudinal direction on driven roller conveyors with contour check
- Gate-based retrieval of the pallets on gravity conveyors with an optional display of a truck loading plan
- Adaptations possible to suit existing structural conditions

MSequence Variant Speed

Pallet load: 1,000 kg
Storage spaces: 176
Storage dimensions of body (WxDxH): 17 m x 8 m x 12 m
Retrieval cycles: up to 106/hour
Double cycles: up to 64/hour



Properties

- Pallet buffer with **quadruple-deep** storage
- Designed for maximum buffer capacity for more than 8 truckloads
- Storage of the pallets in transverse direction on driven chain conveyors with contour check
- Gate-based retrieval of the pallets on driven chain conveyors with an optional display of a truck loading plan
- Adaptations possible to suit existing structural conditions

MSequence Variant Volume

Pallet load: 1,000 kg
Storage spaces: 240 (with quadruple deep)
Storage dimensions of body (WxDxH): 17 m x 8 m x 12 m
Retrieval cycles: up to 94/hour
Double cycles: up to 57/hour

