

# MDynamic

## Automatic container storage

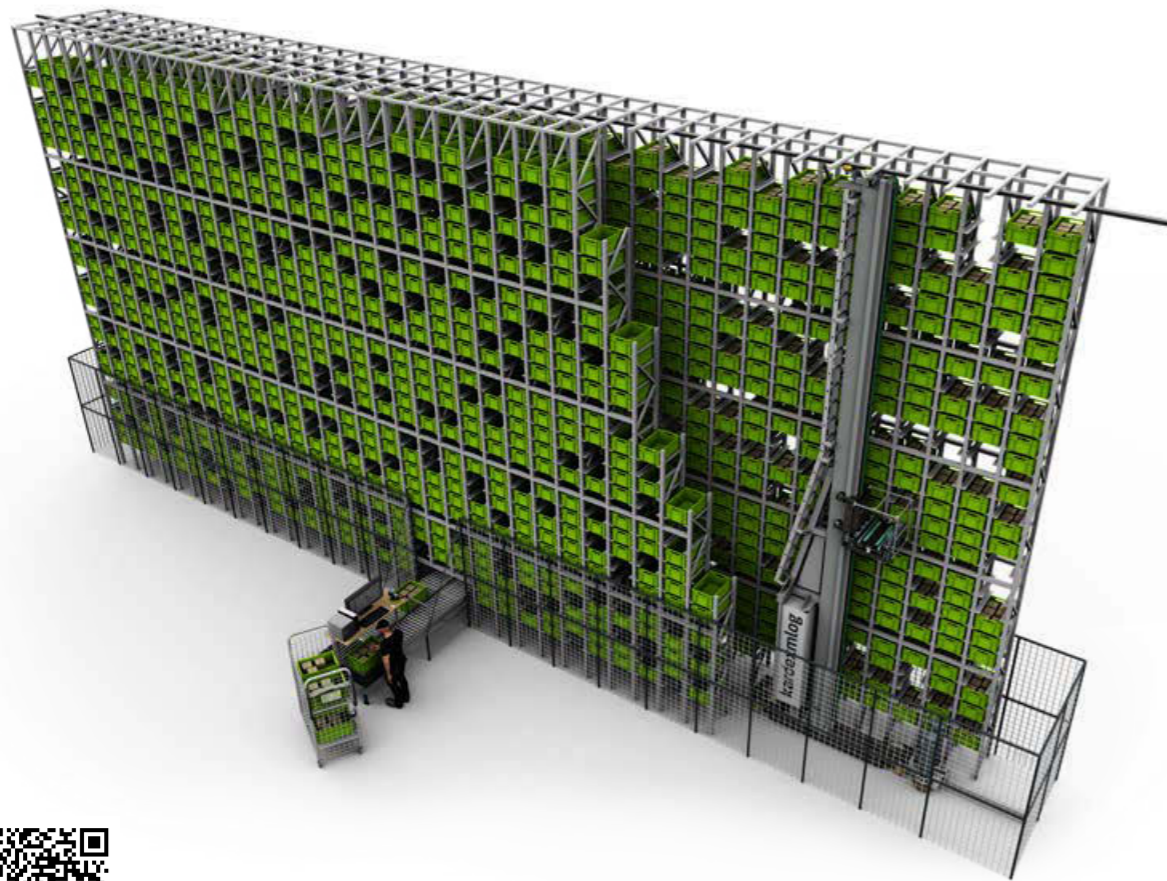

MDynamic  
system solution for  
handling containers

**Overall height:** up to 12 m

**Payload:**

Single-deep up to max. 100 kg

Double-deep up to max. 50 kg

**Length:** up to 90 m

**Storage capacity:**

up to 16,000 containers

**Handling capacity:**

up to 135 double cycles/hour

**Travel speed:**

360 m/min

**Lifting speed:**

180 m/min

**Load carriers:**

Containers 600 x 400 mm

or 640 x 440 mm,

heights up to 420 mm

**Conveyor system:**

Picking module (max. 4)

### Your advantage

- ✔ Turnkey system solution
- ✔ High storage capacity (double-deep storage possible)
- ✔ High throughput
- ✔ Warehouse mgmt software
- ✔ Automatic storage & retrieval
- ✔ Scalable picking modules
- ✔ Easy to integrate
- ✔ Adaptable to building

### MDynamic consists of

- ✔ 1 automatic SRM
- ✔ Racking structure
- ✔ 1 picking unit
- ✔ Control technology (Siemens S7)
- ✔ Warehouse mgmt software
- ✔ Installation & commissioning
- ✔ Training

### Properties

- ✔ Automatic container and picking warehouse
- ✔ Single-deep or double-deep storage
- ✔ Energy-efficient design
- ✔ Complete module (Plug & Play)



The MDynamic system solution is a standardised and modular system designed for the handling of containers. It consists of the components storage and retrieval machine, conveyor system, racking and storage location management.

The storage and retrieval machine with freely selectable overall heights between 5 m and 12 m is equipped with telescopic forks and belt conveyor. It achieves top speeds of 6 m/s at accelerations of up to 3 m/s<sup>2</sup>. This means that up to 135 double cycles per hour can be achieved, depending on the dimension of the overall system.

The conveyor system consists of a picking module with a picking station. Up to two modules can be connected to the side of the racking. They can be integrated in the racking in any desired position without any structural modification.

The racking is designed for single-deep storage of containers of up to 100 kg and is available in variable sizes – height up to 12 m, length up to 90 m. A storage capacity of up to approx. 16,000 containers is possible depending on the size of the warehouse and the height of the containers.

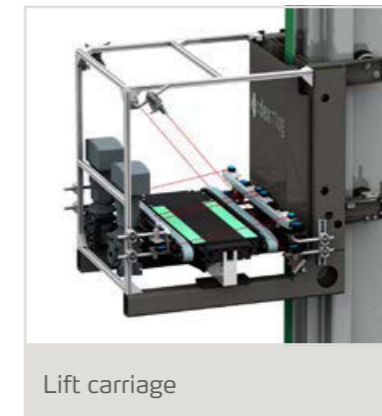

Lift carriage

The MDynamic storage management can easily be integrated into the existing IT environment and can be coupled with any conventional host system.



Containers

